

# BRASERO ACCESSORY

## ASSEMBLY AND INSTALLATION

**Step 01:** Attach the two end plates to the brasero grate with the included hardware - **DO NOT TIGHTEN** until Step 03.

**Step 02:** Install spacer plates (as shown in reference below) on the same side of the brasero grate where it will be used in the grill. For example, if you are using the brasero positioned on the left side of the firebox, then install the spacer plates on the left side. **NOTE:** Rear spacer must be aligned horizontally to simultaneously touch the rear and side walls. Front spacer should be installed vertically, facing inward.

**Step 03:** Fully tighten all fasteners.

**Step 04:** Raise the grates/lift up halfway or more. Place brasero into the firebox and position until the spacers touch the side and rear of the firebox.

### TIPS/CAUTION:

\*Hand-tighten all bolts first to allow for adjustments before fully tightening.

\*Caution: Incorrect spacer orientation may lead to improper fit inside the firebox.

\*This product is powder coated to prevent rust while new. The coating will immediately burn off and is designed to do so. There is no warranty on the coating on this product.

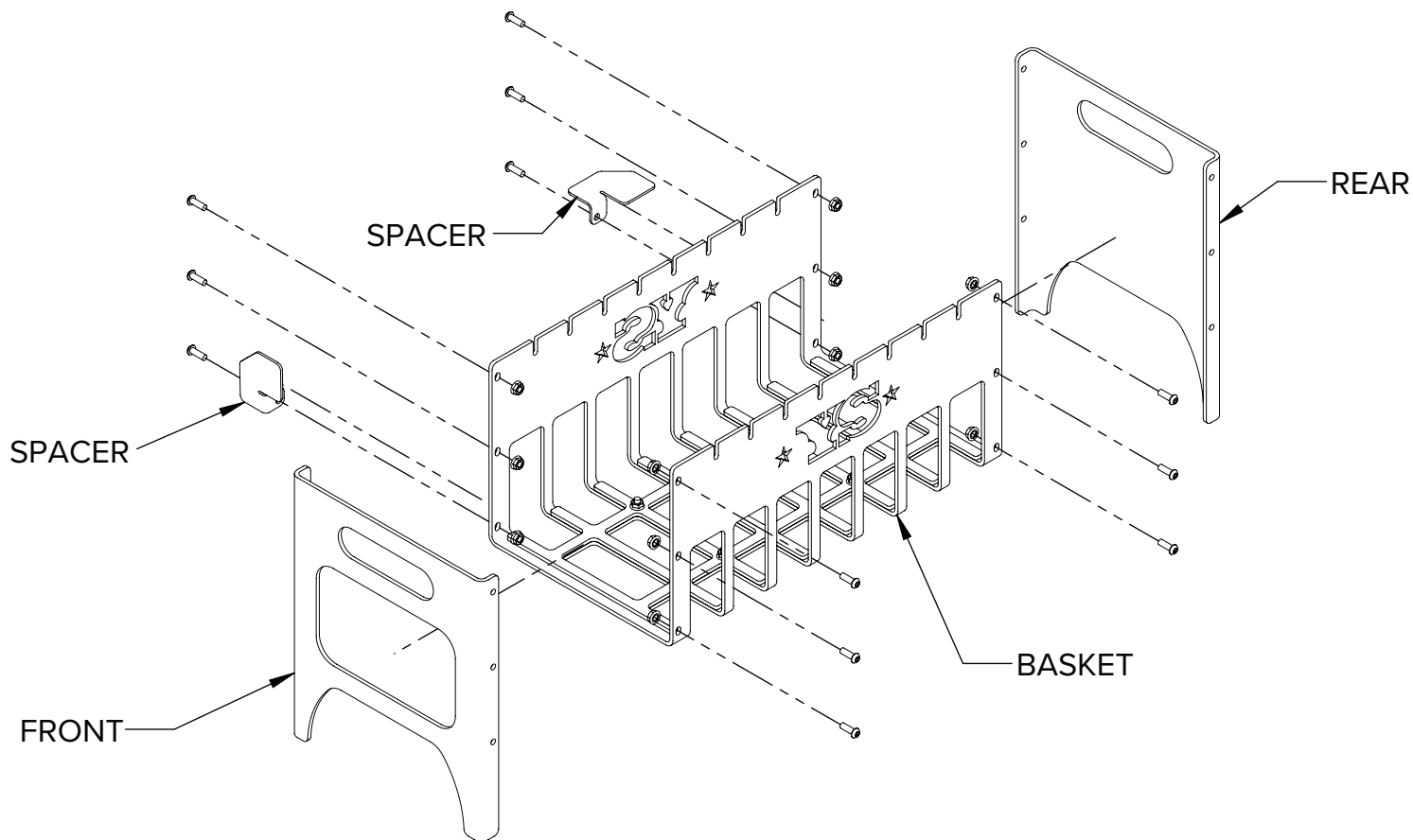

### TOOLS NEEDED:

5/32" HEX/ALLEN



7/16" SOCKET/WRENCH

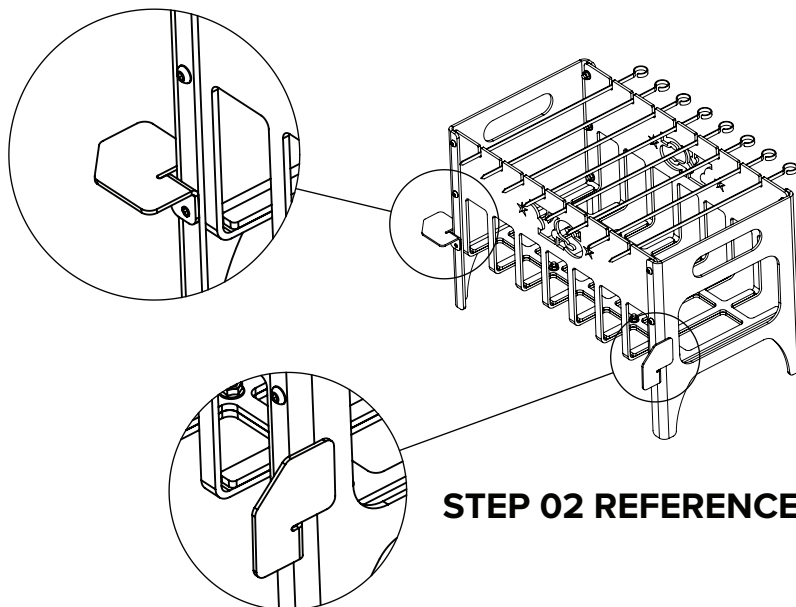
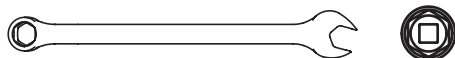

**STEP 02 REFERENCE**